

LED Lamp -1 80W

SOKOYO
Light Up Every Road Back Home



PHILIPS

Top Brand Lumileds LED LUXEON Chips with less Luminous flux decline.



Modular design provides better heat sink Interchangeable for each other.



Crystal clear, anti-scratch, anti-shock Japan polycarbonate lens, IESNA Type II road design

IP67

The whole lamp can work in water Adapt with high humidity and temperature



Maintenance Free Design in service life



Whole lamp aluminum die-casting, anti-rust

Technical Parameters

Lamp Power	80W
Input Voltage	DC 24V
LED Chip	Philips Lumileds
Lamp Efficiency	$\geq 130 \text{ lm/W}$
Luminous Flux	10400lumens
CRI	>75
IK rate	IK08
Color Temperature	5700k
Beam Angle	140°
Life Span	>80, 000 hours
IP Rate	IP67(LED Modular)
Dimensions	645*295*144mm
NET.Weight	5.4kg
Working Temperature	-40°C~ 65°C
Working Humidity	10%~90%RH
Lamp Fixture	High-Pressure Die-Casting Aluminum. Corrosion Resistant
Mount diameter	Diameter 60mm with 304 stainless bolts
Certifications	CE, IEC60598, IP67, IK08
Warranty	3 years

INTENSITY DISTRIBUTION DIAGRAM MAX

INTENSITY DISTRIBUTION DIAGRAM
IN C PLANS

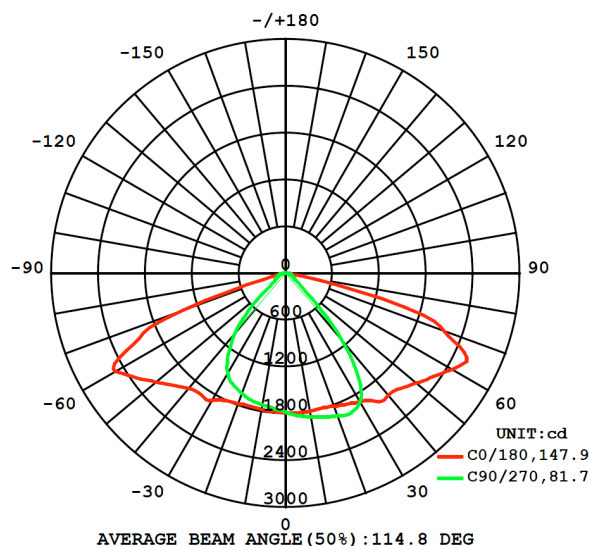

LED Lamp -2

SOKOYO
Light Up Every Road Back Home

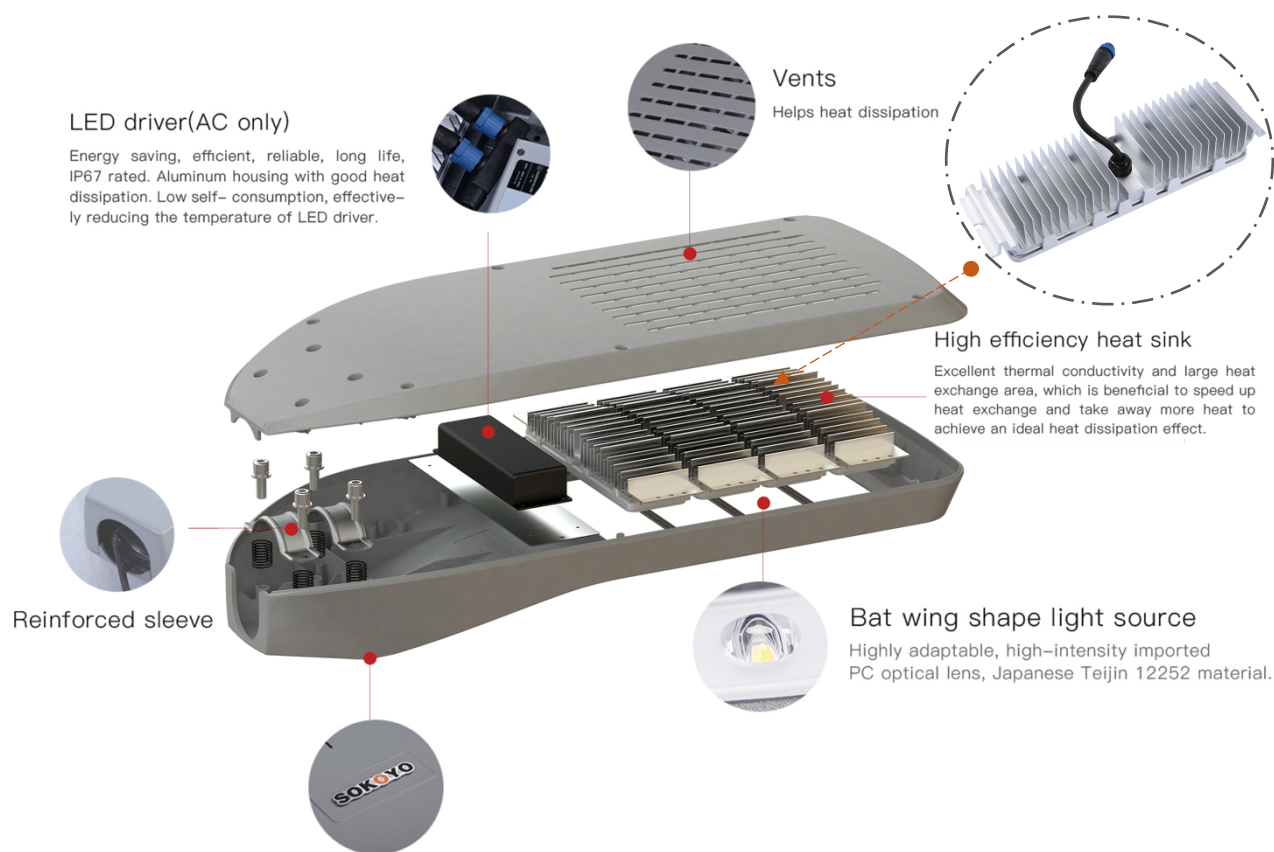

(International) high pressure die-casting aluminum lamp body

With international ADC12 high pressure die-casting aluminum forming, impact resistant
Corrosion-resistant, electrostatic spray treatment after surface shot blasting

Lamp Size

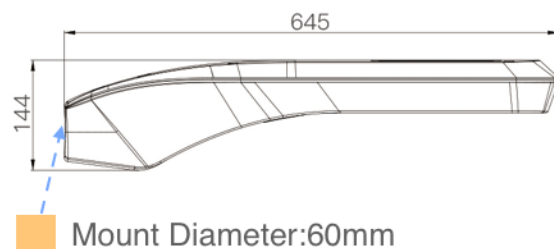
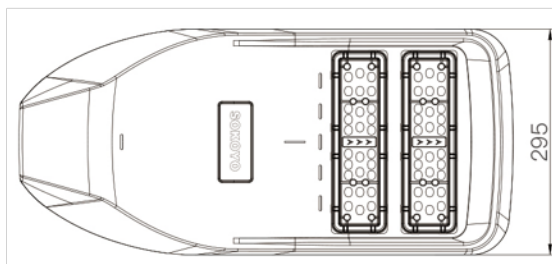

AVAILABLE COLOR

Note: The color is regular color and can be customized



Product Advantages

LED Modular with Japan Lens



Top Class LED Chip Brand



Good Heat Dissipation

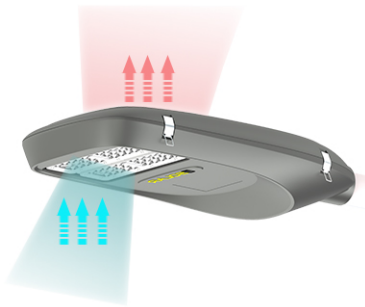

Enable air to convert and fully pass through the gaps between modules by utilizing the honeycomb effect

Whole-structure Heat Dissipation

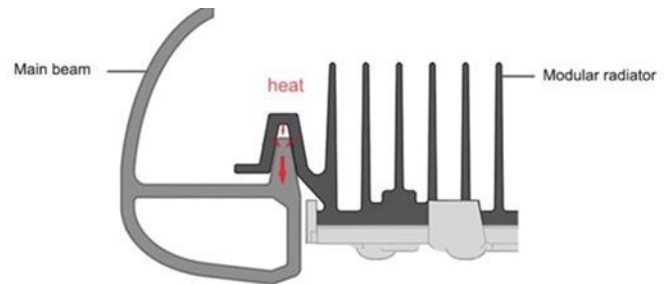

Utilize the surface area of structural parts to transfer heat to air

IP67 waterproof LED modular

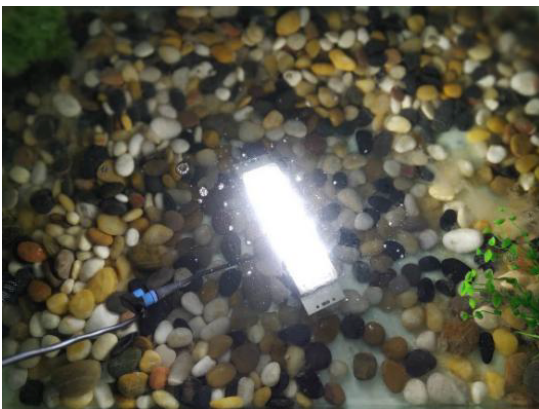

Shock Resistance IK08



Package Display



TOOL ITEM	SPECIFICATION	QTY	Package Details
Open end wrench	10MM	1	QTY/CTN:1 PC
L-type hex wrench	8MM	1	G.W/CTN:6KGS
Six corner cap	M6	10	Package Dimension: L720*W350*H180
Hexagon socket head cap screw	SUS304 M8*16	8	Package Dimension: L840*W380*H185



Real Products Picture front



Real Products Picture back

Installation Notes

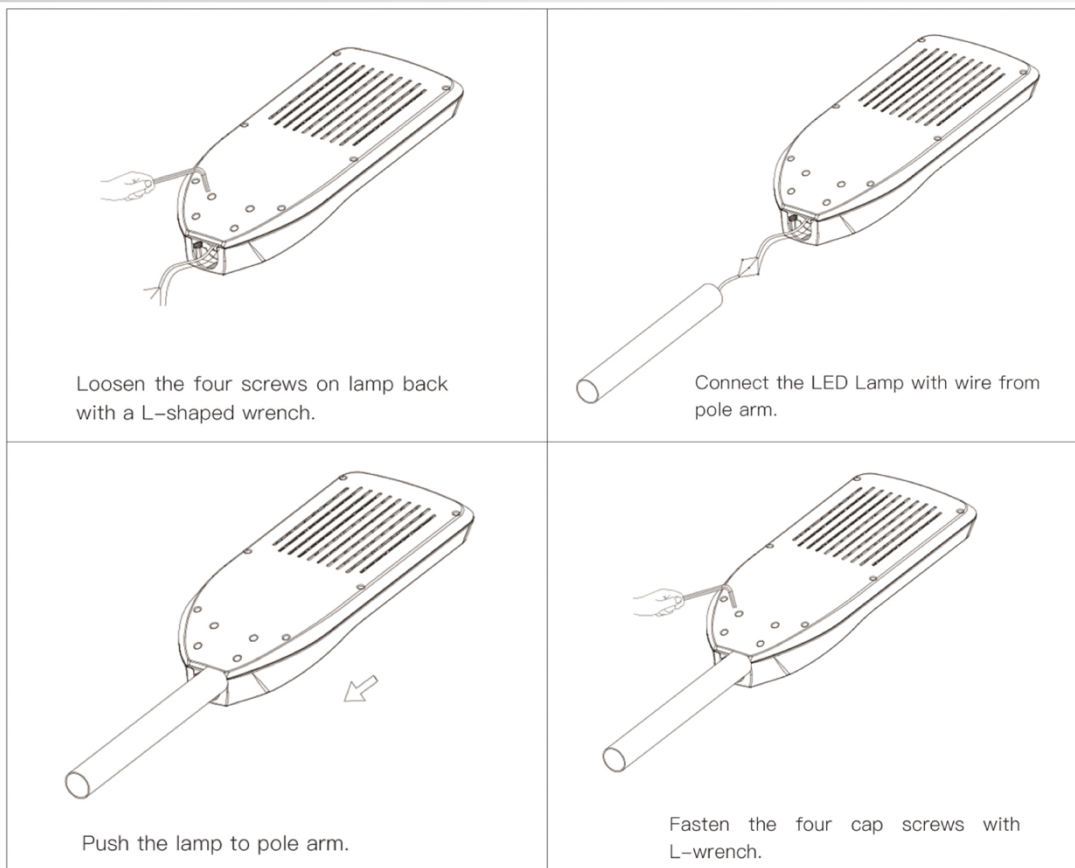

Attentions

- 1、The working voltage of this type of lamp or the configured constant current source according to the product specifications and the reference product label.
- 2、All wiring should conform to the national installation standards, and all joints should be connected and waterproof.
- 3、External lead of lamps and lanterns can not be replaced. If the lead is damaged, the lamps and lanterns will be damaged. Replacement of the lead should meet CCC standards and require qualified persons to replace it in order to avoid the danger.



MODEL C2-72.12
VOLTAGE 12.8V
NOMINAL CAPACITY 70Ah (896Wh)
ASSEMBLY METHOD 4 in series and 12 in parallel(4S12P)
BATTERY Deep-Cycle Lithium Iron Phosphate
CAPACITY PER CELL 6Ah
CYCLE LIFE >1,200 Cycles @ 80% DOD*
APPLICATION Solar street light, Wind-Solar Hybrid and Solar power system

12.8VOLT

PHYSICAL SPECIFICATIONS

BMS	Model	Battery cell Housing Material	Dimensions (mm)			Weight (kg)	Wires
			Length	Width	Height		
SOKOYO	C2-72.12	Aluminium Plastic	516mm+ 2mm	169mm+ 2mm	120mm+ 2mm	8KG	300mm±15mm AWG16 Wire

ELECTRICAL SPECIFICATIONS

Voltage	Capacity Amp-Hours (Ah)			Energy (Wh)	Cycle Life
12.8V	5-Hr (8A)	10-Hr (4A)	20-Hr (2A)	10-Hr	>1,200 Cycles@ 80% DOD @ 20±5℃
	68	70	72	896WH	

OPERATIONAL DATA

Operating Temperature Range	Storage Temperature Range
Charge: 0~60℃ Discharge -10~60℃	Less than 1 year: 0~25℃ Less than 6 months: -5~35℃

CHARGING INSTRUCTIONS

Charger Settings	
Standard Charging Voltage (Recommended)	@ 0.2C to 14.4V
Charging time	Approx 7 hours
Maximum Charging Current @ 25℃	9.0A(8.0A recommended)
Charging Cut-off Voltage	3.6V/cell(≤14.4V)

DISCHARGING INSTRUCTIONS

Electrical Features	
Standard Discharging Voltage(recommended)	@ 0.2C to 10.4V
Maximum Continuous Discharge Current @ 25℃	9.0A(8.0A recommended)
Discharging Cut-off Voltage	2.7V/cell(≥10.8V)

RECYCLE RESPONSIBLY

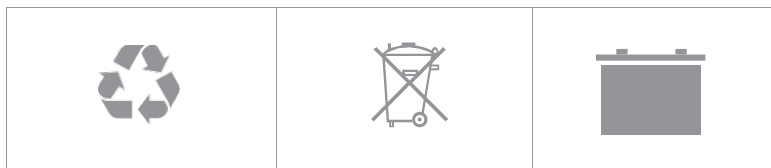

Do not mix with Lead Acid Batteries when Recycling.



System Considerations

As outlined in the User's Guide, Sokoyo batteries will automatically shut down under excessive use conditions in order to prevent damage to the battery and connected equipment. This will generally result in total loss of power to equipment. Systems must be implemented to ensure that sudden loss of power does not result in hazardous system behavior.

BMS and Battery Series Connection	
BMS Protections	Cell-Level Voltage, Temperature, Current
BMS Functions	Cell Balancing
Safety Systems	BMS
Series Connections	4 series
Parallel Connections	12 Parallels

Other Features	
Environmental Protection	IP65
Self Discharge	Battery may be stored up to 3 months then a freshening charge is required
Humidity	60±25R.H.

Noted: Better not to use the battery under extremely cold weather, otherwise the lifespan will be affected.

CYCLE LIFE

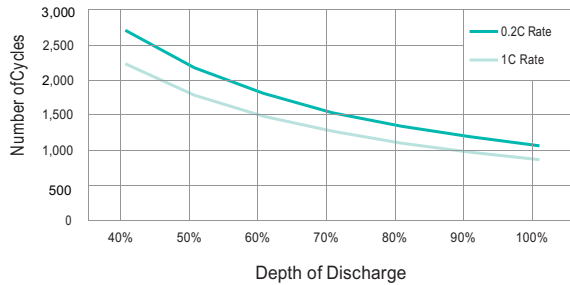

AVAILABLE CAPACITY

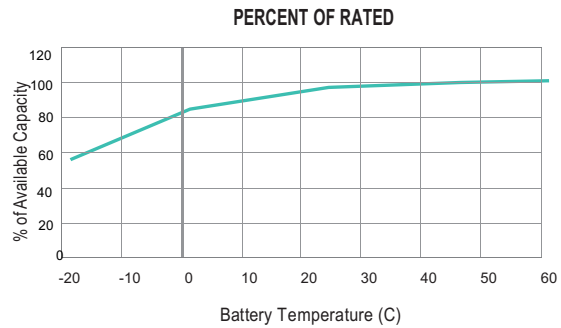

CYCLE LIFE VS. TEMPERATURE

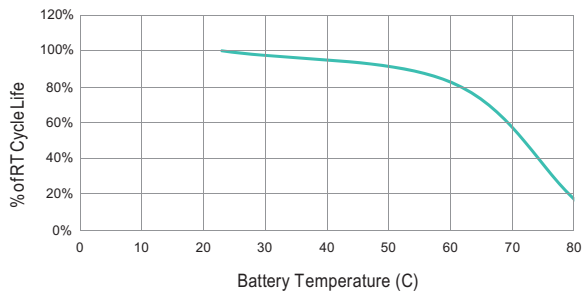

DISCHARGE CAPACITY

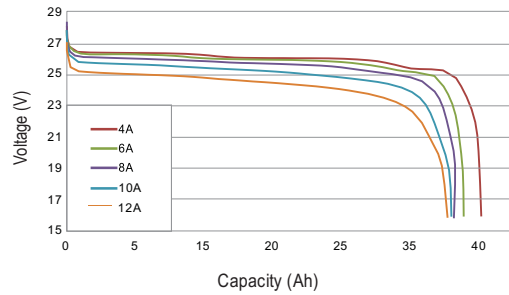

BATTERY PACKAGE DIMENSIONS(mm)

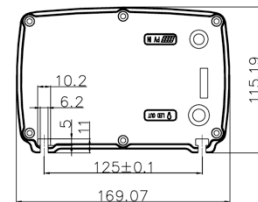
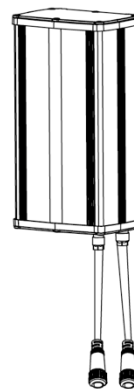
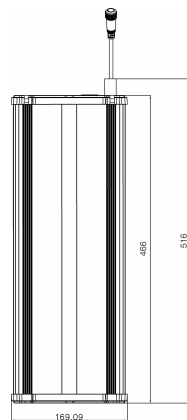

SAFETY/AGENCY INFORMATION

Certified to the Following

UN/DoT 38.3	IEC 62133
ROHS Compliant	UL 1642 (Cells)